

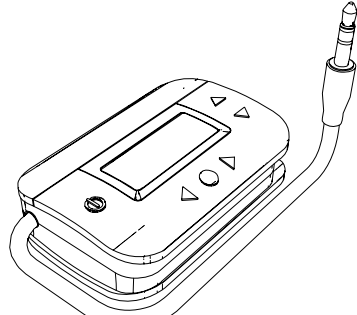

Technical Specifications

- Frequency: 88.1 - 107.9 MHz
- Coverage: Up to 5 M
- Distortion: $\leq 0.5\%$
- Input power: ≤ 20 mAh
- Powered by 2xAAA Batteries



Wireless FM Transmitter
PWFMT1

Functions

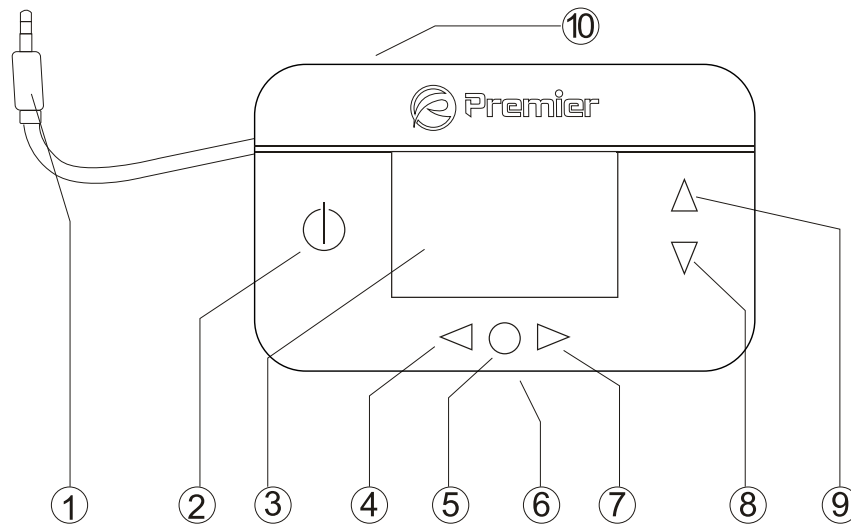

- | | |
|--|--------------------------------|
| ① Audio input from an iPod, Mp3 player or CD walkman | ⑥ DC Power input jack |
| ② Standby button | ⑦ Next Preset frequency button |
| ③ Display | ⑧ Tune Down button |
| ④ Previous Preset frequency button | ⑨ Tune Up button |
| ⑤ Preset Store button | ⑩ USB power input jack |

Features

- Transmit your music wirelessly from your MP3 Players, Apple® iPod®, iPhone®, iPad®, Smartphones and all audio devices with a 3.5mm input
- Supports full frequency range (88.1-107.9 MHz)
- 3 Programmable Memory Buttons
- 3 Power Options - 2xAAA Battery, USB Cable or Car Charger
- Battery Save Mode - Auto Shutoff after 2 minutes of non use
- Low Battery Indicator
- Universal USB Charging Port allows you to charge other devices when the FM transmitter is powered on
- LCD + Backlit Screen - Displays Time, Temperature, FM Station & Battery Level
- Supports Hi-Fi, Super Bass and Stereo Timbre
- Digital PLL Technology ensures radio signal will not be affected in extreme temperature

OPERATION

Power Control

- Press the STANDBY button briefly to switch your FM transmitter to/ from Standby (the clock will display in Standby mode)
- Press and hold the STANDBY button to switch the Power Off/On completely (battery life is extended if Power is switched off).

NOTE:-Your transmitter includes a music sensor to save battery power. If no music is played for one minute, the transmitter will set to Standby automatically.

Setting your FM transmitter and FM radio to the same frequency

- Tune your FM radio MANUALLY to a frequency where no station is broadcasting (you should hear a hissing noise).
- Press the STANDBY button to turn your transmitter on.
- Set your iPod or other music source to Play and turn up the volume.
- Press the >TUNE UP or <TUNE DOWN button to tune your FM transmitter to the same frequency as the radio. Hold the button to tune quickly. You should now hear the music from your source playing through the radio.
- Set the volume on your radio to the level you want. If the volume will not set high enough, turn up the volume on your iPod or other source.
- If your radio has preset station memories you can store this frequency as a pre-set for quick recall whenever you want to use your FM transmitter.

Preset memories

Your FM Transmitter has 10 preset memories so that you can store and recall the frequency.

To store a frequency Memory

- Tune to the frequency to store.
- Press and hold the PRESET STORE button.

The memory display

- Press the PRESET DOWN or PRESET UP button to find the preset number you want to store.
- Press the PRESET STORE button briefly.

The frequency will be saved under this preset number of future recall.

To recall a preset memory

- Press the PRESET DOWN or PRESET UP button to find the preset number you want to recall.

Each preset frequency will be recalled as you scroll through the preset numbers.

DISPLAY

Display when in standby mode

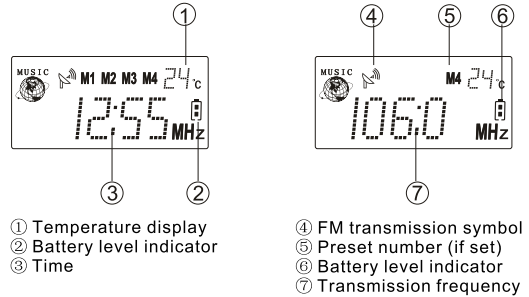

SETTING THE CLOCK

Your FM transmitter includes a clock display.

TO set the clock-

- Press and hold the PRESET STORE button until the minutes flashes.
- Press the > TUNE UP or < TUNE DOWN buttons to set the minutes digits to the correct number.
- Press the PRESET STORE button briefly to set the hours digits.
- Press the > TUNE UP or < TUNE DOWN buttons to set the hours digits to the correct number.
- Press and hold the PRESET STORE button to store this setting.

POWER SUPPLY

You can choose to power your FM transmitter with 2xAAA batteries or car charger (included in package)

INSTALLING BATTERIES

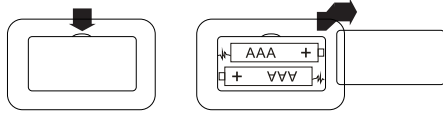

Open the battery compartment cover.
Place 2 x AAA batteries in the battery compartment, observing the polarity

Always use alkaline batteries and replace them. Never mix old and new batteries
Dispose of used batteries with regard to the recycling regulations in your area. Do NOT short circuit batteries or throw them into water, the general rubbish or in a fire.
Weak batteries can leak and damage the player.

CONNECTING TO A CAR POWER CONNECTOR

You transmitter can be powered from the (not supplied) Power Adaptor using the supply available from a car cigar lighter or power connector.

CAUTION

- Use only the DC power adaptor (not supplied). The use of a different adaptor will damage the transmitter and the power supply.
- Never operate the controls or change the connections to your FM transmitter when driving.

TO connect the power supply

- Remove the batteries from your FM transmitter
- Connect the DC plug from adaptor cable into the DC input jack on your FM transmitter.
- Push the adaptor body into a suitable power socket.

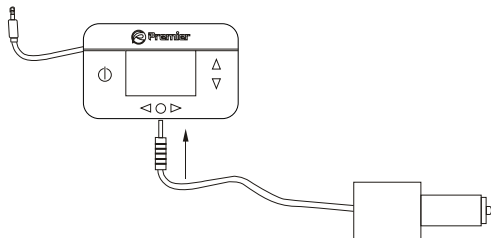

CONNECTING USB POWER

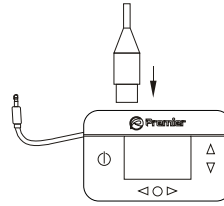

Your FM transmitter can also be powered from the USB jack of a computer.

To connect to a USB jack-

- Connect a suitable USB cable (not supplied) to the USB connector on the top of your FM transmitter.
- Connect the other end of the USB cable to the USB connector on your computer.

CONNECTING A SOURCE

Unwrap the audio input cable.

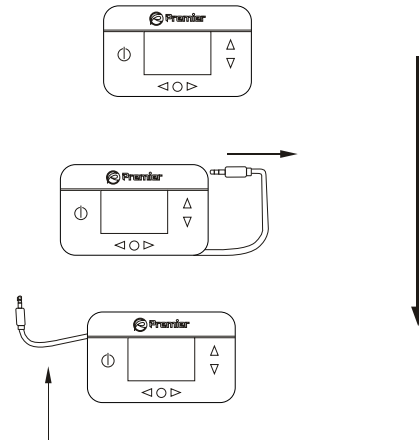

Connect the 3.5mm jack to the 3.5mm input jack on your mobile audio devices.

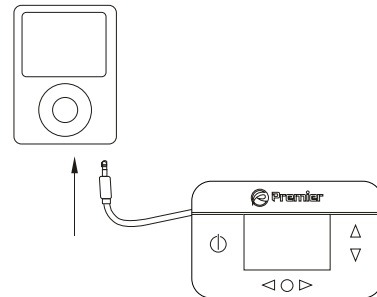

iPod and iPhone are trademarks of Apple Inc., registered in the U.S. and other countries. For additional information or questions about this product call us toll free at 888-446-4327 or email us at info@premierxsre.com